

Quick start-up guide

Welcome!

Thank you for buying a Yale safe.

Before operating your new Yale safe, please read the user manual and fitting guide to ensure maximum performance.

For any inquiries visit www.yalelock.com



Please do not store the mechanical override keys inside the safe.

Setting your user code

1 unlock door

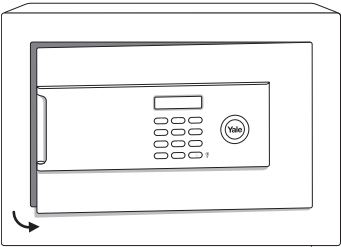

2 ENTER + 3

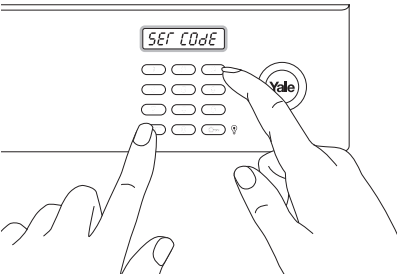

3 code → → code →

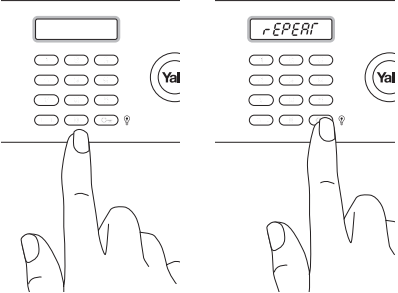

4

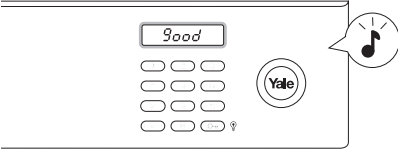

Opening the safe

1 press **ENTER**

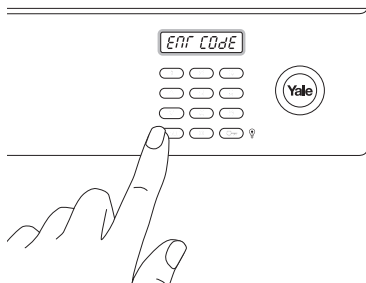

2 code → **ENTER**

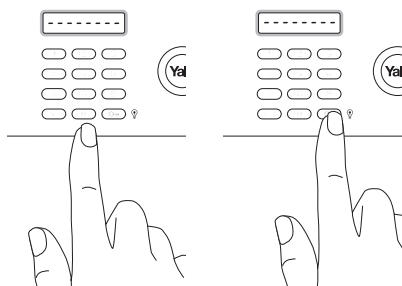

3

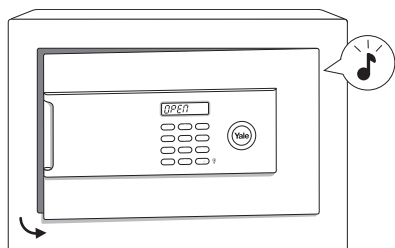

Closing the safe

1 close door

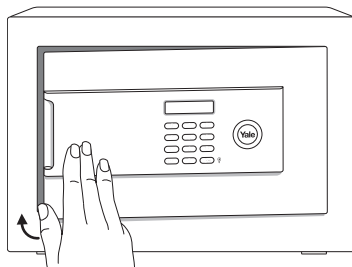

2 **ENTER** → **ENTER**

